

**MOEN® 摩恩**

**不锈钢围边厨盆**

安装说明书

**Stainless Steel Apron Sink**

INSTALLATION INSTRUCTIONS

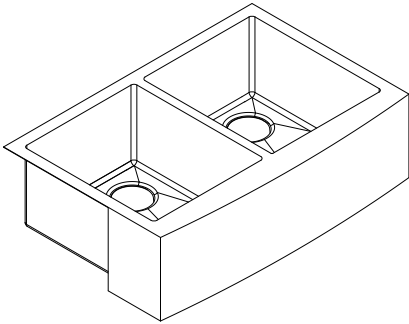

如需安装支持，配件丢失等，请联系MOEN。  
(中国) 400-630-8866  
[www.moen.cn](http://www.moen.cn)

PLEASE CONTACT MOEN FIRST  
For Installation Help, Missing or Replacement  
Parts  
(China) 400-630-8866  
[www.moen.cn](http://www.moen.cn)

**推荐工具**

为了安全和让安装和替换变得容易，Moen建议您使用以下工具：

**HELPFUL TOOLS**

For safety and ease of replacement, Moen recommends the use of these helpful tools.



图片仅供参考  
(款式因型号而异)

Image is for reference only  
(Style varies by model)

记录购买的型号：  
(保存安装说明书以备将来参考)

Record Purchased Model Number:  
(Save instruction sheet for future reference)

原材料厚度：盆胆1.2mm，面板1.5mm  
执行标准：GB/T 38474-2020  
制造商：摩恩(上海)厨卫有限公司  
电话：400-630-8866  
地址：中国(上海)自由贸易试验区富特北路399号

## 安装步骤 Installation Step

1

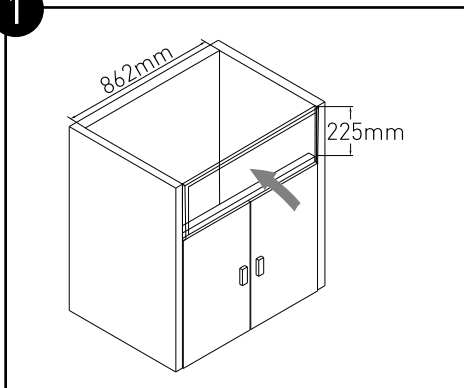

按照盆的安装尺寸预留开孔柜体尺寸。  
温馨提示：开孔时请根据搭配龙头预留足够的安装空间。

Cut out cabinet size.

Reminder: Please leave enough faucet installation space according to actual faucet.

2

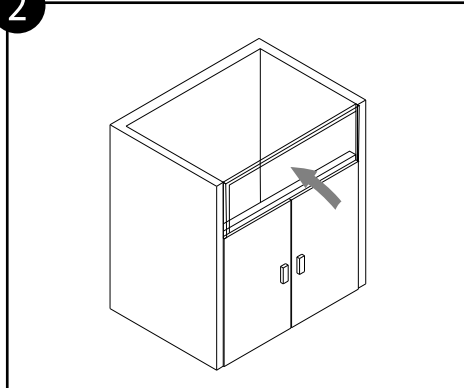

拆除加强板。

Remove false drawer front from your cabinet.

3

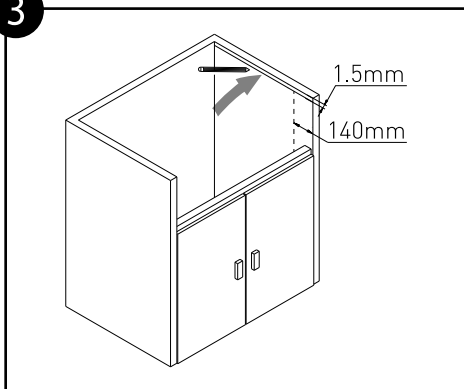

按照图示尺寸在橱柜两侧画线。

Mark the support mounting locations as shown.

4

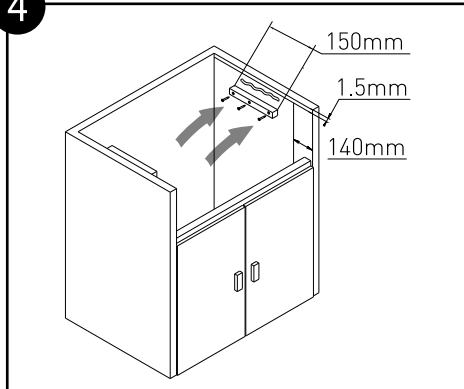

在画线下方涂上玻璃胶用于固定支撑条，确保支撑条的顶面和画线对齐，用螺丝固定。

Apply silicone sealant below the lines. Cut two lengths of support framing to extend along the inside walls on each side of the base, ensuring the sink rim will sit at or slightly below the top edge of the cabinet. Then fix the support framing.

5

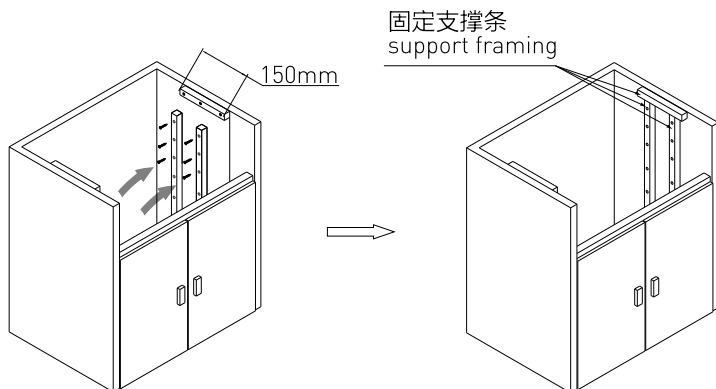

在橱柜两侧横向支撑条下方安装两条相同厚度的竖支撑条，并上螺丝锁紧。竖支撑条必须延伸至橱柜最底部。

Position and fix two lengths of support framing of the same thickness of the top support to extend from the bottom of the installed supports to the floor of the cabinet.

6

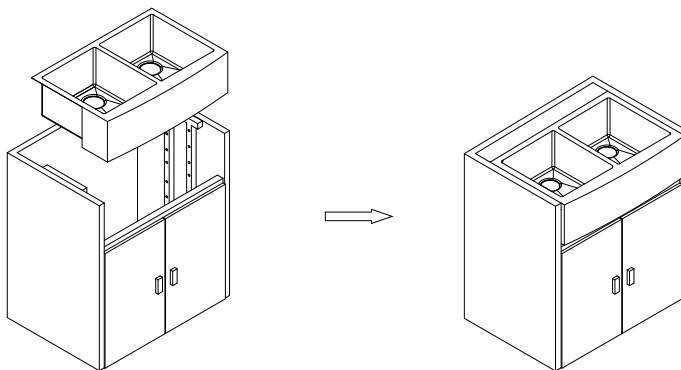

把盆放在两边的横向支撑条上，确保厨盆水平放置。

Verify the sink is level, make any adjustments and shim as needed.

7

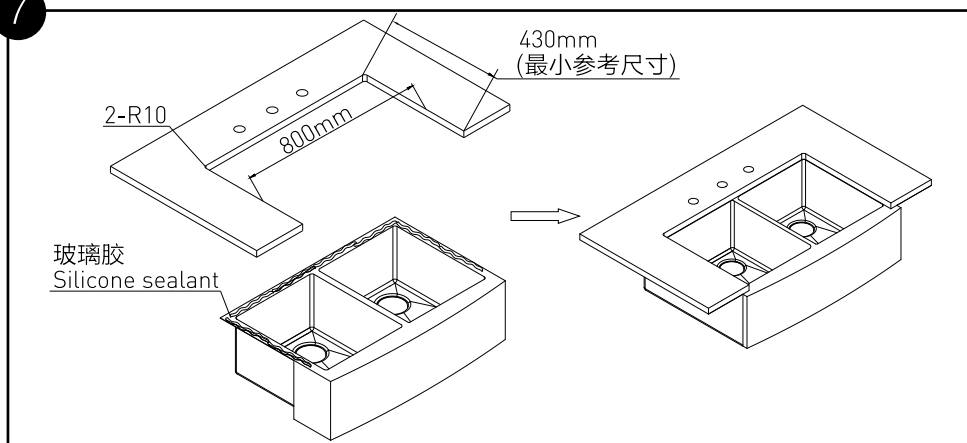

将玻璃胶涂在厨盆三个边上（按图示），将开好孔的台面平压在盆边上。

Position pre-cutout countertop onto the sink rims which glued.

8

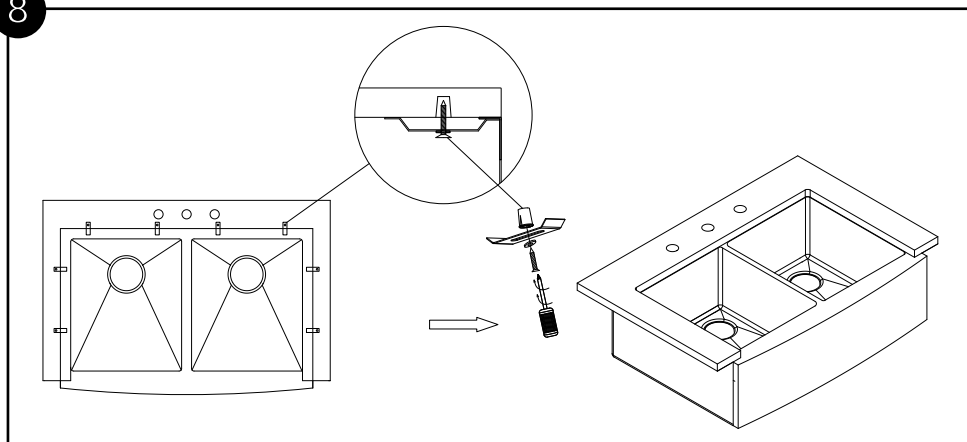

用夹子将厨盆固定在台面底部（夹子必须跟台面的边缘和盆的边缘咬合，厨盆后方最少4个，盆的左右两侧最少各2个）。

注意：安装夹子过程中要注意避开龙头的位置及支撑条的位置。

Install the clips to the countertop, ensure each clip engages the rim (Minimum 4 clips in back, 2 clips per side). Tighten evenly.

Keep away from tap hole area and support area during clips installation.

9

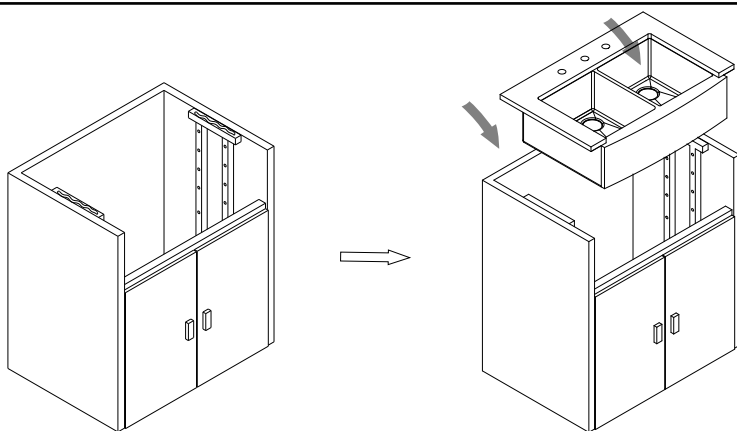

在支撑面上涂上玻璃胶，将台面安装好。

Apply a bead of silicone sealant to the top of each support.

10

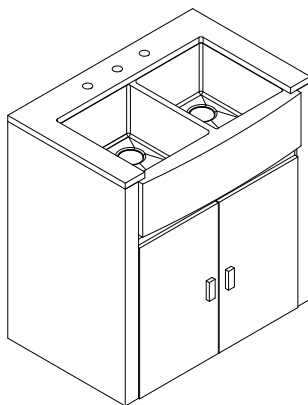

完成台面安装后，用布擦拭水槽边缘的胶水并清除盆内安装时残留的杂物。

Complete counter installation and wipe away any excess caulking from sink rim.

## 产品保养

### 注意事项：

- 厨盆使用完毕后，用清水冲洗并擦干。
- 不能使用钢棉擦洗厨盆。
- 请经常用海绵或布清洁厨盆。
- 对付污渍，可不定期地用温和的洗涤剂清洁并用清水冲洗干净。
- 当用温和的洗涤剂清洁时，可掺上些磨料，轻轻擦洗。
- 不要在厨盆里使用橡皮垫，因为橡皮垫下的污垢很难消沾。
- 含重金属成份的水（重水）会导致厨盆变色或产生锈斑，发生这种现象可在每次用完之后用毛巾擦干。
- 尽量避免强力漂白粉、家用化学品和肥皂长时间接触你的厨盆，如果发生上述情况，则需用水清洗并立刻擦干。

## Care and Cleaning

### Important Information:

- Rinse sink after use and wipe dry.
- Never use steel wool.
- Clean sink frequently with a sponge or cloth.
- For stubborn stains, use a mild non-scratch formula cleanser and rinse well.
- When using a mild cleanser, rub gently with the grain.
- Do not use rubber mats in sink, since the materials trapped under mats are hard to clean.
- Water with heavy metals (hard water) may result in a brown or rust colored stain. If noticed, dry the sink with towel after each use.
- Avoid strong bleaching powder, household chemi-cals and soaps from coming in contact with the sink. If it occurs, rinse and wipe dry quickly.

## 产品售后保修条款

摩恩产品是在质量标准及生产工艺下制造的，摩恩承诺为消费者购买的洁具产品提供有限免费保修及终身维修服务。

不锈钢厨盆免费保修期为5年，均自消费者购买日（以摩恩产品分销商开具的发票或收据上载明日期为准）起计。免费保修范围为产品及产品配件（落水以及溢水等）由于材质及工艺原因而造成的故障或损坏。免费保修期内，我们将无偿为您提供修理服务及更换发生故障的产品或产品配件。摩恩的售后服务责任仅限于对故障产品的修理，而不延及您因产品故障而发生的其他损失，法律另有规定的除外。

您需了解：产品外观碰伤、刻划痕迹，以及滥用及不正当保养所导致的故障或损坏，均不属于免费保修范围。即使在免费保修期内，属下列（1）-（5）情况之一的，需酌情收取修理费用：

1. 不能出示相符的保修卡和有效购买凭证情况的，
2. 未按使用说明书告知的使用方法和注意事项造成的故障，
3. 自行拆卸、维修、改装所造成的故障和损坏，
4. 由于不可抗力等外部原因引起的故障和损坏，
5. 由于运输、搬卸、挤压等造成的损坏。

对于保修期外或不在保修范围内的产品，如需维修，摩恩将酌情收取上门费、人工费及材料费。

本保修条款仅对原始消费者和酒店行业的购买者有效，并不适用于本产品工业、商业、贸易和非酒店行业的使用。

如对本保修条款内容有任何疑问，请拨打400 630 8866咨询热线，或向当地分销商咨询。

## MOEN LIMITED WARRANTY

We offer limited warranty and lifetime maintenance for Moen products, which are all manufactured with high standards of workmanship.

The period of warranty shall start from the date of purchase of the product (according to the invoice or receipt issued by Moen distributors) and shall cover a period of the following: the warranty period for stainless steel sink is 5 years.

This warranty is your coverage against material and workmanship malfunction or defects in Moen products or components (Pipe kit etc.). During the warranty period, we offer free maintenance and changing of malfunctioned products or product components. Moen's after sales service liability is limited to the maintenance of faulty items and does not cover your other losses caused by product malfunction, except for otherwise stipulated by law.

Cosmetic damages (scratches, dents, etc.) and malfunction or defects caused by abuse or improper maintenance is not covered by this warranty. Although the warranty period remains valid, in case of the following conditions (1) - (5), the maintenance cost (material cost and labor cost) shall still be charged as the case may be:

1. Corresponding warranty card and valid invoice cannot be presented;
2. Faults were caused by the incompliance with the instructions and precautions provided in the user's manual;
3. Damages and faults were caused by self-actuated dismantling, repair and refit;
4. Faults and damages were caused by external factors such as force majeure;
5. Damages were caused by transportation, unloading and extrusion, etc.

This warranty is valid for the original consumers only (including hotel use), and excludes industrial and commercial use of the product (except for hotel use). This card is only responsible for product maintenance rather than any other liabilities.

In the event that the product requires maintenance but exceeds the warranty period, or that the product is not covered by this warranty, labor cost and material cost shall be charged as the case may be. Please call 400-630-8866 or contact local dealer for any question.

**MOEN® 摩恩**

**合格证**  
Compliance Certification

产品名称 不锈钢周边厨盆  
Product Name Stainless Steel Apron Sink

检验员 \_\_\_\_\_  
Inspector \_\_\_\_\_

生产日期 \_\_\_\_\_  
Date of Production \_\_\_\_\_

富俊汇赢科技（上海）有限公司  
中国（上海）自由贸易试验区新杨公路  
1800弄1号4幢207室  
邮编：201413  
Fortune Brands Innovations (Shanghai) Co., Ltd  
Room 207, Building 4, No.1, Lane 1800, Xinyang Highway,  
China (Shanghai) Pilot Free Trade Zone