

MOEN® 摩恩

SINGLE HANDLE SINGLE MOUNT LAVATORY FAUCET

MODEL 11121/11122/11221/11124 SERIES

单孔单把手面盆龙头

型号 11121/11122/11221/11124 系列

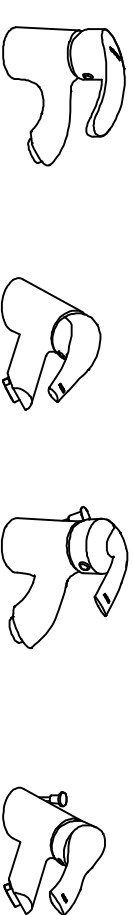

11122

11121

11222

11221



11124



11224

HELPFUL TOOLS 应备工具

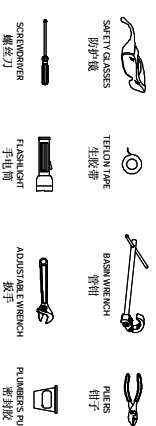

1

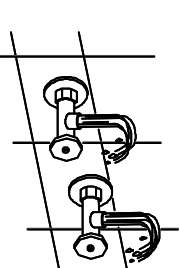

ENGLISH
CAUTION: Always turn water OFF before removing existing or disassembling the faucet. Open faucet handles to relieve water pressure and ensure that complete water shut-off has been accomplished.

中文

注意：在更换或拆卸龙头前，首先一定要关掉水源。然后打开龙头，释放水压，并检查水路，确保其彻底关闭。

1. 打开冷热供水，排去管内积累的残渣。否则将有损龙头。

五 (5) 年有限质保证书

摩恩的产品是在高质量标准及生产工艺下制造的。摩恩公司保证原始消费者和酒店行业购买者在五 (5) 年期间内 (从购买者的原始收据所示的日期起生效)，如果龙头芯轴有渗漏或滴水现象，摩恩公司将免费提供所需配件以使该龙头恢复到良好使用状态。

其他附件如软管、花洒、落水、把手、装饰盖、提拉杆、混水器等产品的保修期均为1年有限。所有产品的外观碰撞、划痕痕迹等不属于保修范畴。以上保证仅对原始消费者和酒店行业的购买者有效，并不包括本产品。在工业、商业、贸易和非酒店行业的使用。以及由于安装错误，产品滥用、水压不高、水中杂质过多及不正当的保养所导致的问题，无论这些损坏是由建筑承包商，服务公司或由用户本人安装所造成的。摩恩公司对在安装、维修、替换等方面所引起的人工费用或产品损坏将不负责，对连带的后果性损坏也不负责任。

此保证书的最终解释权归摩恩公司所有。

服务卡

感谢您回答下列问题，以便我们能更好的为您服务。

您的地址：

电话：

传真：

您的职务：

系列：

数量：

您所使用的产品的名称：

型号：

地点：

产品用于： 一般家用 高级公寓 商务场所 其他

酒店：

星级：

有无净化水设施： 是 否

您是如何知道我们的产品的：

报纸媒介： 一般家用 高级公寓 商务场所 其他

您对我们产品和服务的要求：

合格证

摩恩(上海)厨卫有限公司
中国上海市浦东新区银城中路168号
上海银行大厦1001室 邮编：200120
热线电话：021-53854898

MOEN® 摩恩

组装厂：广州摩恩水暖器材有限公司

地址：广州天河沙河上元岗 (510507)

检验员：

生产日期：

MOEN® 摩恩

©2003 Moen Incorporated, 25300 Al Moen Drive, North Olmsted, Ohio 44070-8022 U.S.A.

INS1301A - 5/08

In Canada: Moen Inc, 2816 Bristol Circle, Oakville, Ontario L6H5S7
中国，摩恩(上海)厨卫有限公司，上海浦东新区银城中路168号上海银行大厦十楼1001室

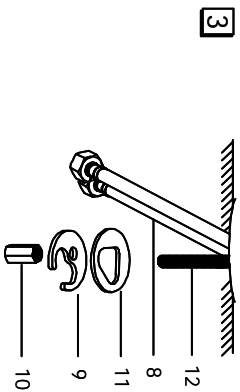
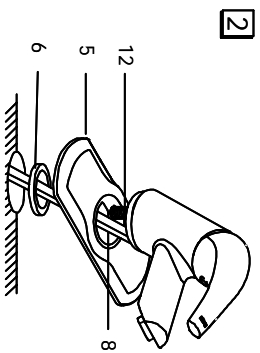

ENGLISH

2. Be sure the mounting surface is dry and clean. Unthread the supply line assy (8), thread the mounting stud(12), attach the escutcheon(6) through the mounting stud(12) and re-thread the supply line assy (8) through escutcheon to the spout. Position the faucet on the mounting deck after guiding the supply line assy. (8) through the spacer(6) and deck.

中文

2. 首先确保安装台面的清洁, 干燥。先拧下软管(8), 拧入固定螺栓(12), 将面板(5)穿过固定螺栓(12)再将软管(8)拧进阀体内。将软管套入垫片(6)穿过台盆孔后, 将龙头放在正确的位置上。

★先从阀体上拧下软管(8)

3. From below, assemble the lower deck gasket(11), mounting horseshoe(9) and mounting nut(10) to the mounting stud(12). Tighten the mounting nut(10)(do not over-tighten). Connect the inlet supplies to the hot and cold water supply lines. Turn on the water and check for leaks.

3. 接着安装下垫片(11), 垫块(9)和固定螺母(10)到固定螺栓(12)上, 拧紧螺母(10) (注意不要用力太大, 以免损坏螺纹), 分别把两根进水管软管接到冷热水管上, 最后给龙头供水, 检查是否漏水。

CARTRIDGE DISASSEMBLY

芯轴拆装

ENGLISH

1. Pry out plug button(6), unthread set screw(7) and pull off the handle(1).

3.(Note:Check the position of the cartridge to aid proper replacement) Remove cartridge(3) by pulling out of faucet. 4. For re-assembly, reverse the steps on reverse side.

中文

1. 拆下红蓝塞头(16), 拧下螺丝(17), 并拆下手柄(1)。
2. 拧出帽盖(2)和芯轴螺母(15)。

3. (注意: 观察芯轴的正确安装位置以帮助正确的更换) 从龙头里把芯轴(3)拔出。
4. 重新装回时, 按反步骤安装以上零件。

POP-UP WASTE INSTRUCTIONS

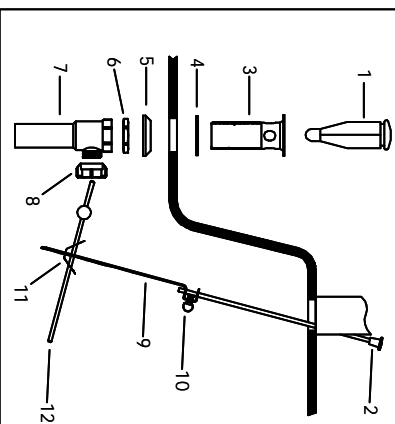

ENGLISH	中文
1 Drain Plug	落水塞
2 Lift Rod & Knob	提拉杆
3 Seal	去水座
4 Top Gasket	垫块
5 Bottom Gasket	胶圈
6 Mounting Nut	螺母
7 Drain Body	落水管体
8 Pivot Nut	连接轴杆螺母
9 Lift Rod Strap	调节板
10 Spring Clip	调节板螺丝
11 Pivotal Rod	弹簧夹
12	连接轴杆

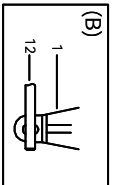
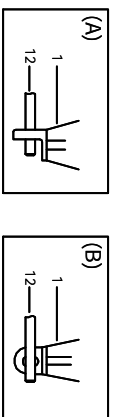

ENGLISH

1. Place top gasket(4) under seat(3).
2. Trace mounting nut(6) and bottom gasket(5) onto drain body(7).
3. Position drain body(7) up through drain opening and screw seat(3) onto drain body(7).
4. Align the drain body(7) so that the pivot nut(2) opening faces the rear of the sink and tighten the mounting nut(8).
5. Drop in drain plug(1) and install pivot rod(2) in one of the following ways:
(A) VANDAL PROOF: Prevents unauthorized removal of drain plug(1). Place the pivot rod(2) into the opening and position the pivot rod(2) through the drain plug(1) hole as shown in illustration(A) above. Slide the pivot nut(8) onto the pivot rod(2) and thread it snugly onto the drain body(7); be careful not to over-tighten.

中文

1. 将座垫(4)放在去水座(3)的下面。
2. 把螺母(6)及胶圈(5)装到落水管体(7)上。
3. 将落水管体(7)向上穿过落水孔, 把去水座(3)拧入落水管体(7)中。
4. 把落水管体(7)放置于适当的位置, 以便与连接轴杆(12)相接, 然后拧紧螺母(8)固定;
5. 安装落水塞(1), 然后选择下面两种中的其中一种方式安装连接轴杆(2):
(A)锁位式: 可防止随意拿下落水塞(1)。将连接轴杆(12)装入落水管体(7)的开口处, 连接轴杆(12)放进并插入落水塞(1)的孔内, 如A图所示, 套上连接轴杆螺母(8), 并旋好, 不要旋得太紧。

(B) EASY REMOVAL: For quick removal of drain plug(1) for cleaning follow instructions above except position parts as shown in illustration(B) above.
6. With lift rod(2) in position on the faucet insert the end into the lift rod strap(9) and secure with lift rod strap screw(10).
7. Connect the pivot rod(2) to lift rod strap(9) using spring clip(11) as shown above.
8. Place the drain plug(1) in the full open position, loosen lift rod strap(9) screw and adjust the lift rod & knob(2) height so that the knob clears the faucet. Tighten the lift rod strap screw(10). Installation is now complete.

(B)可移式: 可以随时将落水塞(1)取下, 便于清洗, 安装连接轴杆(12)时参照B图, 其它与锁位式相同。
6. 将提拉杆(2)穿过龙头, 插入调节板(9), 把调节板螺丝(10)拧上。
7. 按图示例用弹簧夹(11)连接调节板(9)和连接轴杆(12)。
8. 把落水塞(1)放在全开的位置, 松一下调节板螺丝(10), 上下调节提拉杆(2)的高度直至满意, 然后拧紧调节板螺丝(10), 安装结束。

FIVE (5) YEAR LIMITED WARRANTY

Moen Products have been manufactured under the higher standards of quality and workmanship. Moen warrants to the original consumers and hotel purchasers that should cartridge ever develop a leak or drip during this 5 year warranty period, Moen will FREE OF CHARGE provide the parts necessary to put the product back in good working condition. This warranty shall be effectives from date of purchase as shown on purchase's receipt.

Warranty period of other accessory such as hose, hand shower, waste assembly, handle, cover, lift rod, aerator are 1 year. All the products' scrap, mark and etc are not in warranty field.

This warranty is valid for the original consumers and hotel purchasers only and excludes industrial commercial, or non-hotel business use of the product. product damage due to installation error, product, abuses, or product misuse, whether performed by a contractor, service company, or yourself. Moen will not be responsible for labor charges and/or damage incurred in installation, repair, or replacement, not for incidental or consequential damages.



MOEN (Shanghai) Kitchen&Bath Products CO.,LTD

1001C, the 10th floor, Bank of Shanghai Plaza
168 Yincheng Road Middle, New Pudong district
Shanghai 200120 P.R. China

请您将此卡寄到下面地址, 谢谢!

寄: 摩恩(上海)厨卫有限公司
上海市浦东新区银城中路168号
上海银行大厦十楼1001室 邮编: 200120
TO: MOEN (Shanghai) Kitchen&Bath CO.,LTD
1001C, the 10th floor, Bank of Shanghai Plaza
168 YinCheng Road Middle, New Pudong District
Shanghai 200120 P. R. China