

DESCRIPTION

- Metal construction with chrome finish
- G1/2 inlet connections

OPERATION

- Lever style handle
- Pull-on / Push-off
- Temperature controlled through 110 degree arc of handle travel
- Include spout diverter function, rotated angle is 180°

FLOW

- Flowrate is 21.4 L/m at 0.3±0.02 MPa with aerator

CARTRIDGE

- Ceramic 40 mm cartridge design
- Nonmetallic / nonferrous and ceramic material

STANDARDS

- Designed to meet GB 18145 standard

WARRANTY

- 5 years limited warranty against leaks and drips

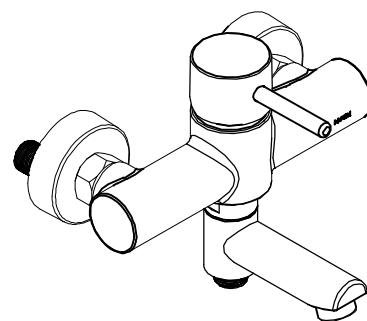

CHARMANT
Wall Mount Tub Shower Faucet
With Swiveling Spout
Model: HK2885

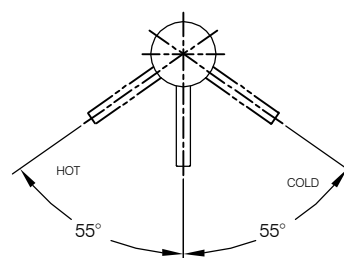
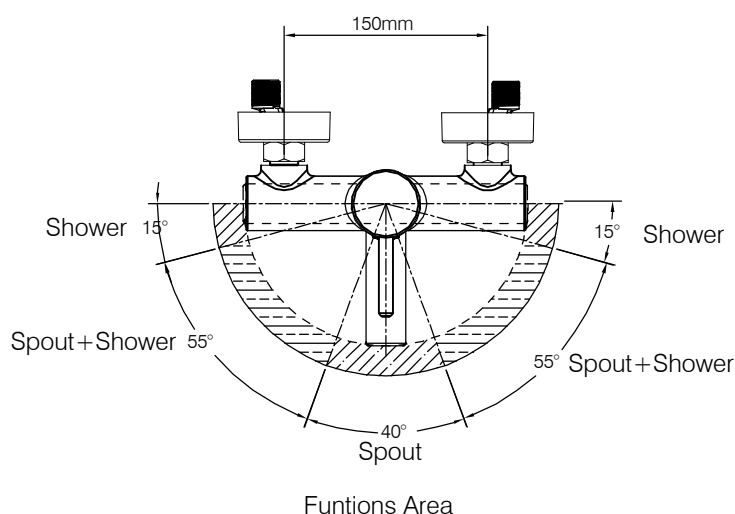
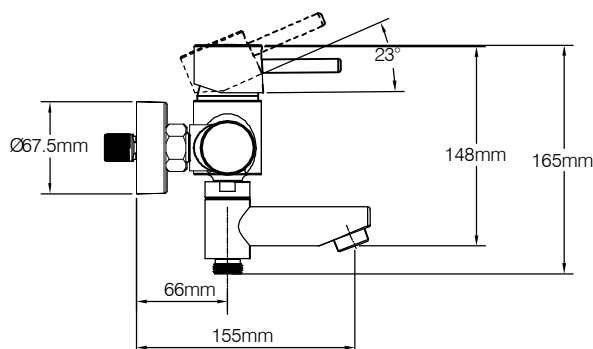
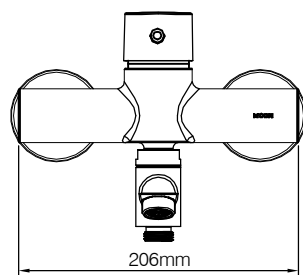

CRITICAL DIMENSION

(DO NOT SCALE)