

# MOEN® 摩恩

## Specifications

### DESCRIPTION

- Various finishes identified by suffix
- Reflex™ pulldown system offers smoother operation, easy movement and secure docking
- 3-function wand technology provides the maneuverability for cleaning or rinsing
- Waterfall mode provides a powerfully concentrated rinse for faster clean up and less splash
- G1/2 inlet connections
- 600mm flexible supply lines with G1/2" compression fittings
- Pulldown spray with 1350mm braided hose
- High arc spout provides height and reach to fill or clean large pots while pulldown wand provides the maneuverability for cleaning or rinsing
- Hydraulic self-powered (No electricity storage), when the ambient illumination below 10lux, the water pressure of 0.3Mpa and the water flow is not less than 5L/min, the illumination of LED light is not less than 75Lux at a distance of 10cm below the nozzle and a radius of 5cm
- 360° rotating spout provides ability to install handle on either side

### OPERATION

- Lever style handle, temperature controlled by 100° arc of handle travel
- Operates in stream or spray mode in the pulldown or retracted position

### FLOW

- Stream water flowrate is about 3.0 L/min to 4.5 L/min at 0.1 Mpa
- Water flow difference is limited to 3.0 L/min maximum from 0.1 Mpa to 0.3 Mpa

### CARTRIDGE

- MOEN Duralast cartridge

### STANDARDS

- Designed to meet GB 18145; GB 25501

### WARRANTY

- 5 years limited warranty against leaks and drips

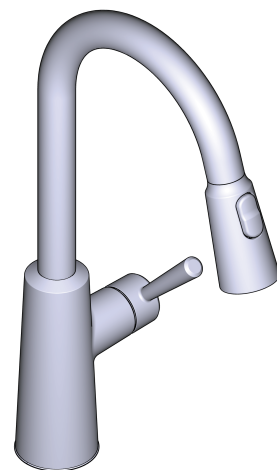

### Riley

One-Handle Pulldown Kitchen Faucet

MODELS : GNMCL7402HPseries

NOTE: THIS FAUCET IS DESIGNED TO BE INSTALLED THRU 34mm MIN. TO 38mm MAX.DIA.HOLE

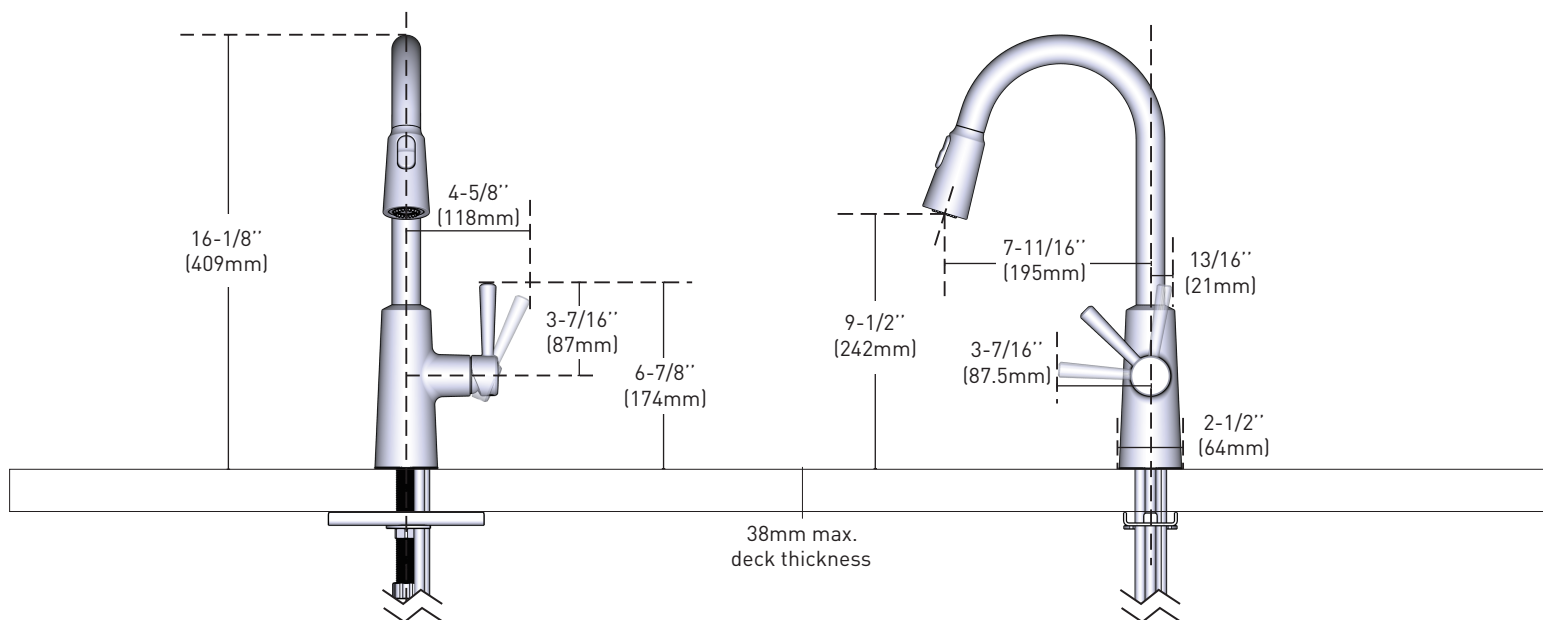

CRITICAL DIMENSIONS DO NOT SCALE